

THIS DOCUMENT AND THE INFORMATION CONTAINED HEREIN ARE PROPERTY OF MINNESOTA ELECTRIC TECHNOLOGY INC. AND MUST NOT BE REPRODUCED, COPIED, OR DISCLOSED TO OTHERS EXCEPT AS SPECIFICALLY AUTHORIZED BY MINNESOTA ELECTRIC TECHNOLOGY INC.

REVISION HISTORY		DESCRIPTION	DWG	CHKD
REVISION	DATE		DJG	DL
A	11/15/2011	RELEASED		

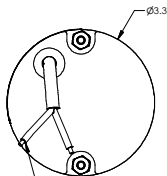

14/2 S.JEOW CORD 17.0
FROM FRAME
JACKET STRIP BACK 3.0
WIRES STRIPPED TO 1±1/8

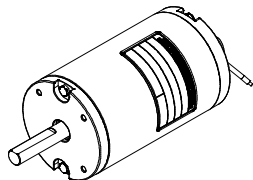
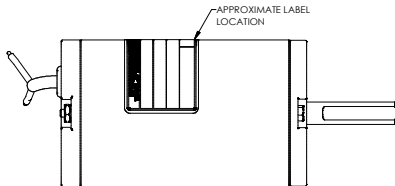
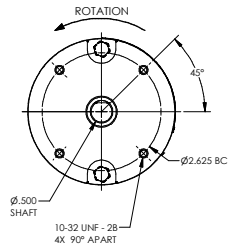
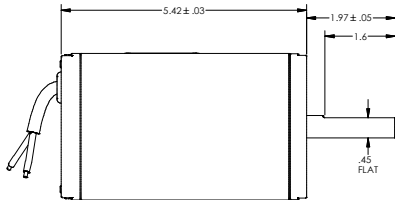

NOTES:

- LEADWIRES MUST NOT BE WIRED TOGETHER WITH A TYRAP ON OUTSIDE

UNLESS OTHERWISE SPECIFIED	
ALL DIM ARE IN INCHES. INTERPRET DIM AND TOL. PER ASME Y14.5M-1994. DO NOT SCALE.	TOLERANCES ANGLE - ± 1' FRACTION - ± 1/64 DECIMAL: .x = ± .05 .xx = ± .01 .xxx = ± .005 .xxxx = +.002/-0.003
THIRD ANGLE PROJECTION	

FIRST USED:	JOB NO: -
MODEL NO: 38-1222452C	
CREATED:	DWG NO:
DJG 11/15/2011	301-0002B-01
MATERIAL:	TITLE
SOURCE PRINT:	OUTLINE

	MINNESOTA ELECTRIC TECHNOLOGY WWW.METMOTORS.COM MANKATO, MN 56001 USA
DWG NO:	REV
301-0002B-01	A
TITLE	SIZE
OUTLINE	C
	SHEET
	1 / 1